

FINDING 'AHC' FROM THE SOUTH, EAST & WEST

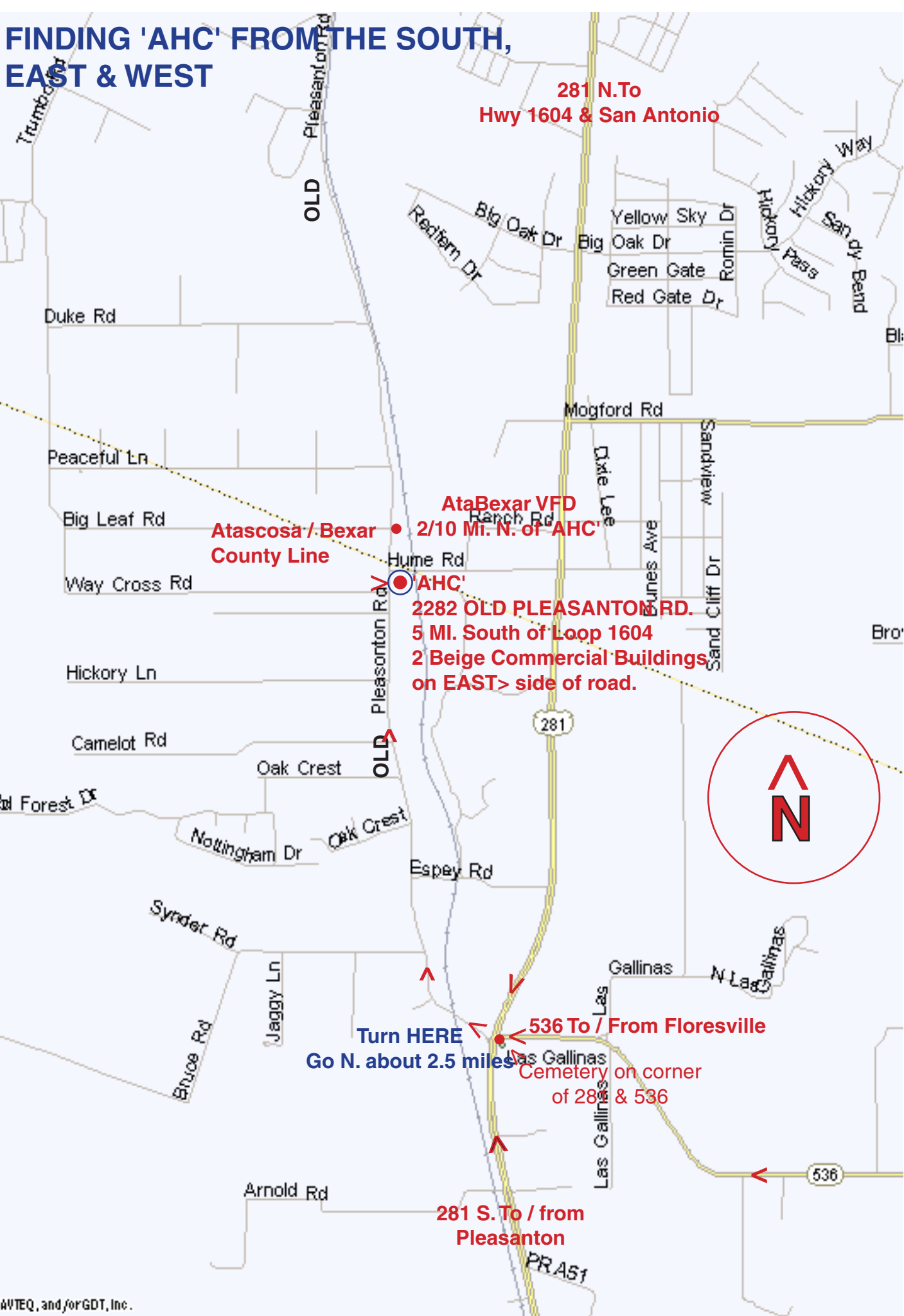

281 N.To
Hwy 1604 & San Antonio

Atascosa / Bexar
County Line

AtaBexar VFD

2/10 Mi. N. of 'AHC'

'AHC'
2282 OLD PLEASANTON RD.
5 MI. South of Loop 1604
2 Beige Commercial Buildings
on EAST > side of road.

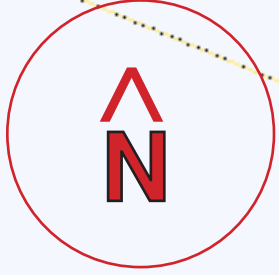

Turn HERE
Go N. about 2.5 miles

536 To / From Floresville

Cemetery on corner
of 281 & 536

281 S.To / from
Pleasanton